

**PRODUCT RANGE**  
WORLD WIDE

**ALPHA GATE MK II™**

**ITAB**

**SHOP PRODUCTS**

The NEW Alphagate MKII is the most advanced, fully featured automatic gate that ITAB Shop Products have created and represents the completion of 12 months research and development, a project targeted at creating a best in class automatic gate which sets new standards in the marketplace.

The Alphagate Mk2 introduces many new features and latest technology components which provide; flexibility, simplified gate configuration and easy interconnection between multiple gates.

### Security and Safety

The Alphagate MKII has an emergency safety anti-panic feature and an audible alarm will sound if the gate arm is pushed into the anti-panic mode. A new feature of the Alphagate MKII is that the gate arm will automatically return to the closed position if it is forced in either direction. The Alphagate MKII has the depth of functionality to offer Standard, Welcome, Secure, Cleaning and Self Checkout modes, all built in to the new control board of the gate.

The Alphagate MKII can also be fitted with safety mechanisms such as Childsafe. The Childsafe function means that the gate arm will instantly stop when a child is standing within the limits of the gate arm. As soon as the safety zone is clear, the gate will open again. Childsafe is available through the option of an integrated rear ultrasonic sensor.

As a standard feature, the Alphagate MKII can also be linked to the store's other security systems such as the fire alarm. The "soft opening" functionality of the Alphagate MKII limits the amount of torque generated in the opening process. This will significantly reduce any risk of potential injury should a person be struck by the gate arm.

### Finishing Options

As with all our products we try to give the best aesthetic look while maintaining our high level of functionality and safety. The Alphagate MKII has this in abundance. The gate comes finished in bright chrome or powder coated in a colour of your choice.



## Standard signage



Entry



Emergency exit



No entry



Model shown: Alphagate MKII - Radar, Right hand, Standard arm.

## TECHNICAL DETAILS

Passage Function	Standard, Welcome, Secure, SCO, Cleaning Mode.
Opening Controls	Pushbutton, Photocell, Radar, Overhead sensor, Remote Control, CAN be linked for true synchronisation.
Signal Type	NPN, 12 Volt
Opening Time	see data
Break-out Facility	Emergency break-out facility fitted with automatic reset at 40-75 Nm at 1 m (adjustable)
Safety	Emergency break-out with alarm, Childsafe Ultrasonic (optional)
Adjustable Settings	Opening delay of Gate arm. Sensor adjustment (if fitted). Adjustable Zero position of gate arm
Gate Functionality	Left or right handed,
Gate Arms	Standard 1100mm (Cut to Size on Site), Full depth arm available in bright chrome or powder coated.
Power Supply	230V/115V 50Hz Directly into the top of the gate or through the floor. 24 Volt motor.
Weight	27,0 Kg

## OPTIONS

- Lead in or lead out customer guide rails.
- Photocell, Radar, Overhead sensor or push button operation
- Standard, Welcome, Secure, Self Checkout and Childsafe available.
- Customer counter can be integrated in the gate or on the uprights.
- A range of gate arms, standard, deep or Adjustable.
- Available in Chrome or RAL powder coat.

## Dimensions

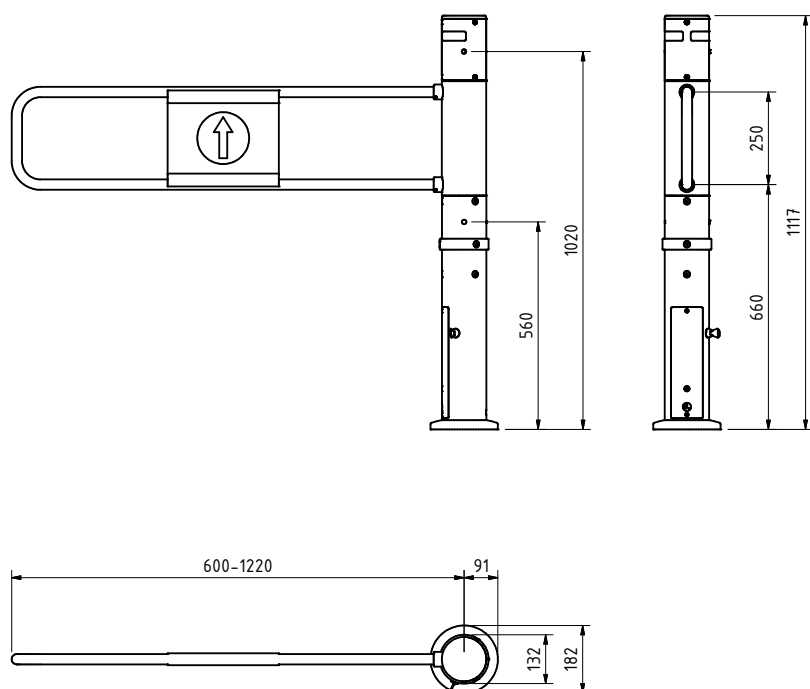

## Footprint

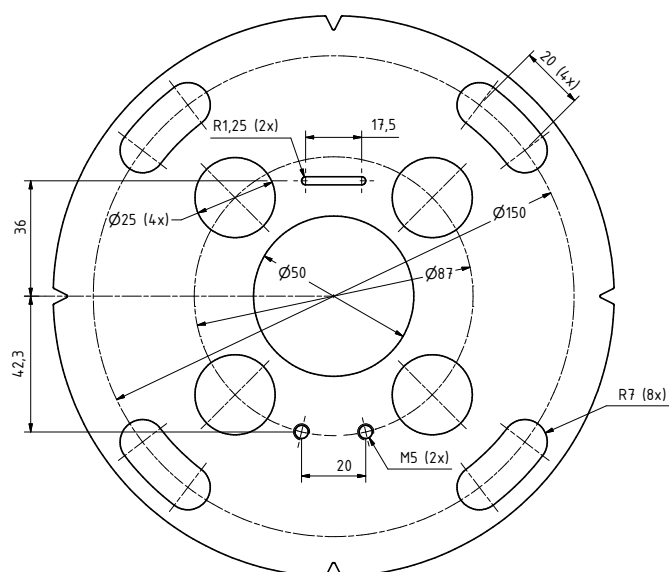

ALPHAGATE MKII

## Features

- Left or Right hand functionality.
- Gate Test button to operate the gate without a triggering device.
- Automatic Break-Out reset (anti-panic).
- Adjustable Break-Out force.
- Multiple communications by GateCOM™
- New User friendly Interface.
- Supports both 230 and 115 Volt AC Power supply.
- SCO-mode supported.
- Welcome/Secure mode can be switched on/off remotely.
- Adjustable alarm time.
- Alarm can be switched on/off.
- Local PEC switch to enable "own" gate to open.
- Fast opening and soft closing sequence.
- Can be installed as a "stand alone" unit.
- Variety of safety features (child safe sensors), soft stop, anti-panic.
- Intelligent directional radar mounted in the top of the gate. Better security than other radars. Customers can not reach over the gate to trigger the sensor.
- Cleaning mode. All gates can be opened at once from a control panel for cleaning machines or deliveries.
- Gate arm is one size and can be cut on site to fit.
- Strong and robust construction.
- Gates can be easily linked for simultaneous operation.

## Technical Data

Break-Out Nm Max:	75 Nm
Break-Out Nm Min:	40 Nm
Opening Time:	1,2 s
Closing Time:	3,5 s
Opening Time Delay (Min):	0 s
Opening Time Delay (Max):	35 s
SCO Close Delay Min (triggered by PEC):	0 s
SCO Close Delay Max (triggered by PEC):	30 s
SCO Time-Out Delay Max:	64 s
SCO Time-Out Delay Min:	3 s
Secure Delay Max:	16 s
Secure Delay Min:	1 s
Childsafe Delay Max:	18 s
Childsafe Delay Min:	2 s

There are 4 potentiometers for various adjustments (from the top):

1. Approach delay time/delay time of the photocell closing in SCO mode.
2. Delay time of the childsafe function.
3. Delay time of the secure function/ultimate timer delay for gate closing in SCO mode.
4. Panic brake out force.

The PCB is equipped with a Test Button to operate the gate without any connected triggering device. This makes the installation and troubleshooting with the Alphagate MKII so much easier.

## PCB

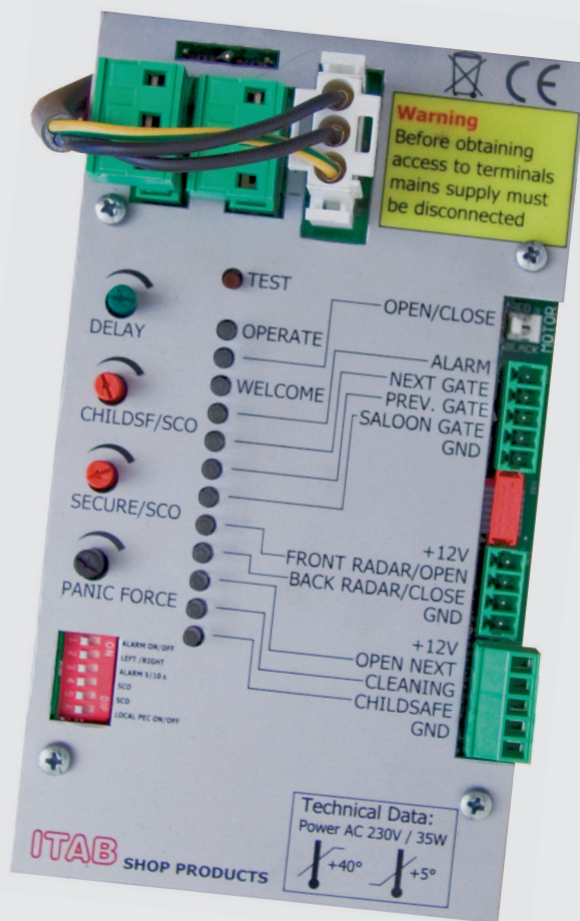

The new PCB for Alphagate MKII has a completely new and improved design. The components have been carefully chosen to give the PCB a longer life span and improved robustness. Our goal for the new PCB was to develop something that would use the most up-to-date component design; facilitate simplified interconnection between the gates; improve the Man-Machine-Interface and prepare it for the future, by equipping it with an USB connection.

The above Illustration shows a clean information board with 12 LED lights for easier installation and a quick trouble shooting. Each function within the gate has a corresponding LED indicator on the control board.

## ITAB Shop Products AB

Box 9054, SE-550 09 Jönköping, Sweden  
Phone: +46 (0)36 299 46 00  
Fax: +46 (0)36 299 46 66

Visiting address: Instrumentvägen 2  
E-mail: info@itabshopproducts.com  
Web site: www.itabshopproducts.com